

<b>EAL-3</b>
<b>EAL-4</b>
<b>EAL-5</b>
<b>EAL-6</b>
<b>EAL-10</b>

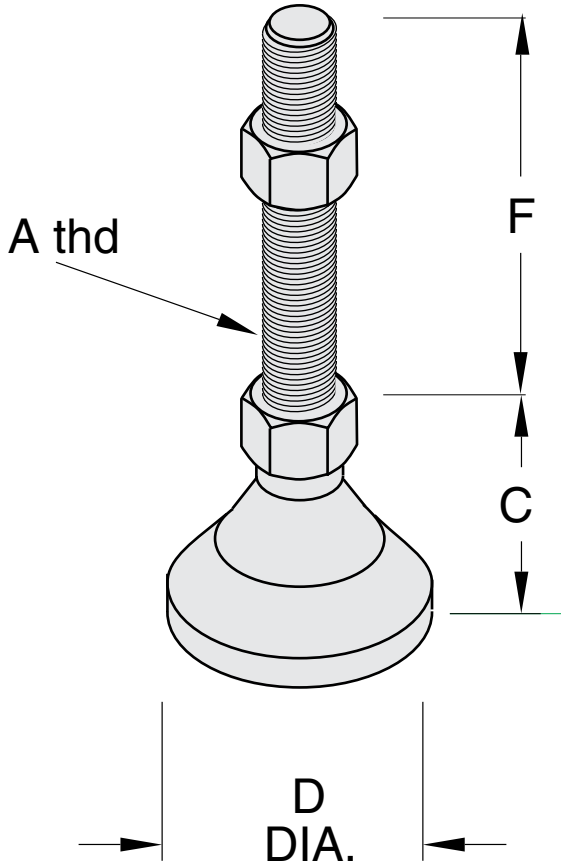

**5/16" SLOTS**

Part No	Max (lbs) Work Load	A	C	D	F
<b>EAL-4</b>	3750	3/8-16	7/8	1 1/4	2
<b>EAL-3</b>	5000	1/2-13	1 1/8	1 7/8	2
<b>EAL-5</b>	6000	5/8-11	1 1/4	2 1/2	2
<b>EAL-6</b>	7200	3/4-10	1 1/2	3	2
<b>EAL-10</b>	2300	5/16-18	1.25	1 1/4	2

**Material - Steel**  
**Finish - Yellow Zinc Plate**