

<b>EAL-7</b>
<b>EAL-8</b>
<b>EAL-9</b>

**5/16" SLOTS**

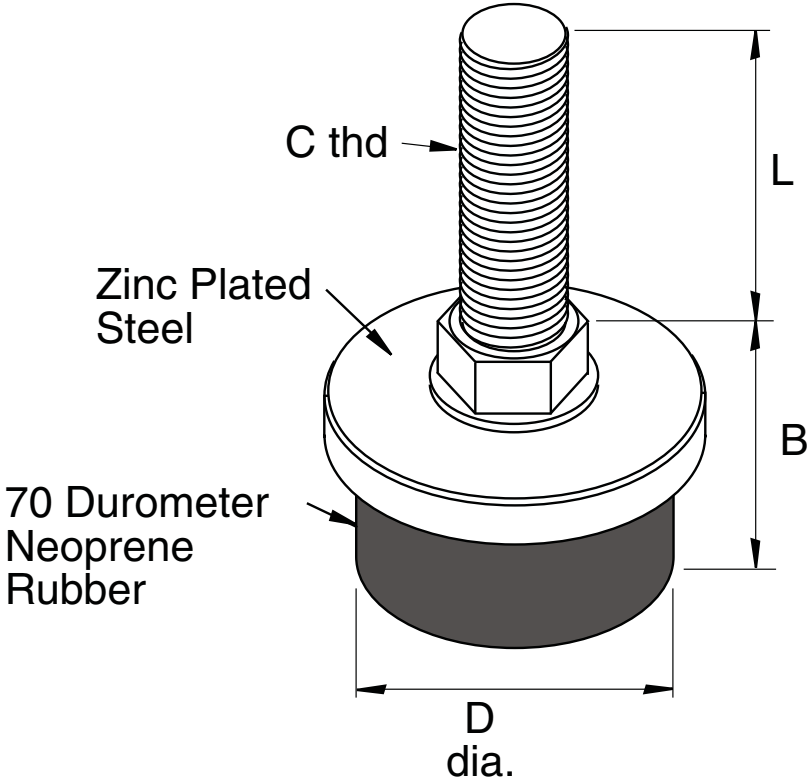

Part No	Max (lbs) Work Load	C Thd Size	D	B	L
<b>EAL-7</b>	100	$5/16$ -18	1.0	$13/16$	$1\ 1/4$
<b>EAL-8</b>	300	$3/8$ -16	1.5	$63/64$	3.0
<b>EAL-9</b>	300	$1/2$ -13	1.5	$1\ 1/16$	2.0